

COMMISSIONING FREEZERS TREATED WITH A NUPLEX FLOOR TOPPING

The commissioning process is very critical to avoid undue stresses and prevent possible structural damage to the concrete floor slab and/or the Nuplex floor topping. Rapid thermal shocking will damage the concrete substrate.

Unfortunately we are unaware of any industry standard for the commissioning process so we have listed below critical aspects and procedures that have proved successful over many years.

CONCRETE FLOOR SLAB

- Must be minimum 25mpa Compressive strength.
- Must be cured minimum 28 days.
- Moisture content less than 75% RH, 18% WME or 4% actual moisture content.

Note: Trapped moisture will expand within the concrete when frozen. The concrete must be able to withstand the tensile forces created.

NUPLEX FLOOR TOPPING

- Must be fully cured. Once the temperature is lowered below 5°C curing will cease.
- Full cure generally takes 5-7 days at >20°C/75% RH.
- Floor toppings must be isolated from freezer walls to avoid cracking due to differential movement or compression of the insulation under the floor when fully loaded.
Options include:
 - Aluminium cove section fixed to wall and sealed to floor.
 - Refer details page 2.

COMMISSIONING PROCESS

The condensers in the freezer units are very effective at removing moisture from concrete and may be utilised to speed the dry of the concrete floor slab.

Step 1

Lower temperature to 0°C and hold for 2 days.

Step 2

Lower temperature at 5°C increments and hold for 2 days at the temperature.

Step 3

Repeat the process until required temperature is achieved.

Coolroom Cove Detail for Nuplex Sureshield, Industrial Terrazzite and Supascreed Flooring

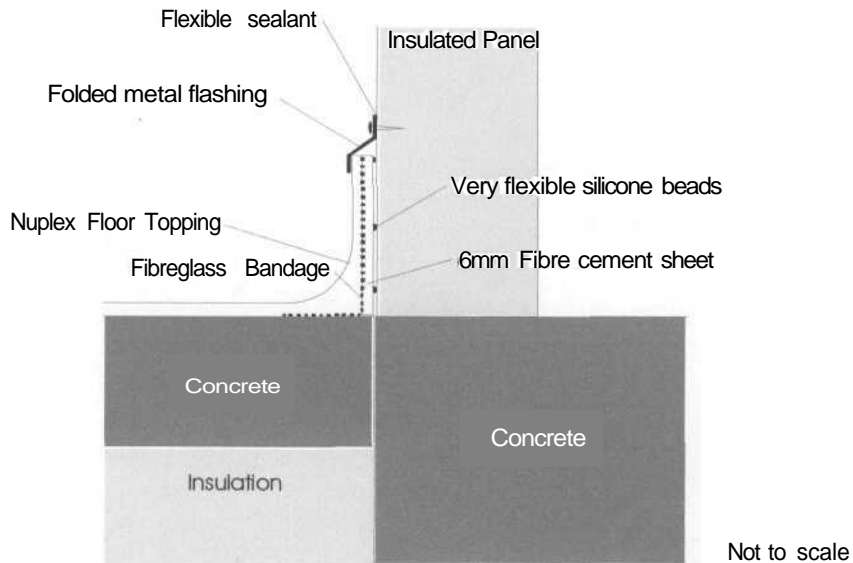

Isolates cove from Coolroom walls to allow for floor movement due to compression of the insulation

No warranty either expressed or implied or statutory is made by NUPLEX in this document except as expressly stated in any sale and purchase agreement entered into between NUPLEX and the buyer. This document is a technical data information sheet. The description of the product or products and the properties of the product or products contained in this document is for the sole purpose of identifying the product or products and describing their property or properties and does not constitute a warranty that the product or its properties shall conform to that description; nor is the description of the product and/or its properties a warranty by NUPLEX that the goods are suitable for a particular purpose.



Certified ISO 9001
Reg. No. 158